

TOWN OF MEETEETSE

J. W. Yetter, Mayor
Dustin Taylor, Councilman
Josh Blake, Councilman
Corey Guthrie Councilman
Eric Scott, Councilman
C, K,K,& K, Town Attorney
Winfred C. Orrell, Jr., Municipal Judge



Angela Johnson, Clerk Treasurer
Ronee Hogg, Deputy Clerk
Shawn Christopherson, Public Works
John Lundberg, Public Works Assit
David Schlenker Deputy Sheriff
Deputy Sheriff

P. O. Box 38
Meeteetse Wyoming 82433
Phone 307-868-2278, Fax 307-868-2608 Email: meeteetse@tctwest.net

APPLICATION FOR DEER/TURKEY ARCHERY PERMIT

Name: _____

Mailing Address: _____

Primary Place of Hunting: _____

Ordinance Changes-Allow Archery Hunting only in Town Limits in specific locations, must have a valid hunting license for Deer- Hunting Areas- 116 and 165, Turkey- Hunting Areas- 4

- Archer Hunter Must Initial Each Requirement and Acknowledge:
 - _____ Obtain a valid hunting license and archery license through Wyoming Game and Fish for Deer or Turkey
 - _____ Obtain a special hunting permit through the Town of Meeteetse for Deer or Turkey- town permits are issued on first come first serve basis and at the Towns discretion/signed waiver.
 - _____ Limitation to Archery only-Type1 ,3, 6, 8-
 - _____ Hunting in only designated areas/ obtain a map from the Town on designated areas
 - Follow Wyoming Game and Fish Standards and Regulations including asking property owners to hunt on their land.
 - _____ Spring- Turkey Tom's only
 - _____ Fall- Turkey any bird
 - _____ Deer- designated by hunting license type

- I, HUNTER) _____
- I HEREBY RELEASE THE TOWN OF MEETEETSE, MAYOR AND COUNCIL, TOWN OF MEETEETSE STAFF ASSOCIATED THEREWITH FROM ALL LIABILITY, INCLUDING CLAIMS AND SUITS OF LAW OR IN EQUITY FOR ANY INJURY, FATAL OR OTHERWISE, WHILE PARTICIPATING IN ANY OF THE HUNTING ACTIVITIES.
- _____
- DATE _____
- SIGNATURE _____

Date: _____

Signature: _____

Approved _____

Denied _____

J.W. Yetter, Mayor

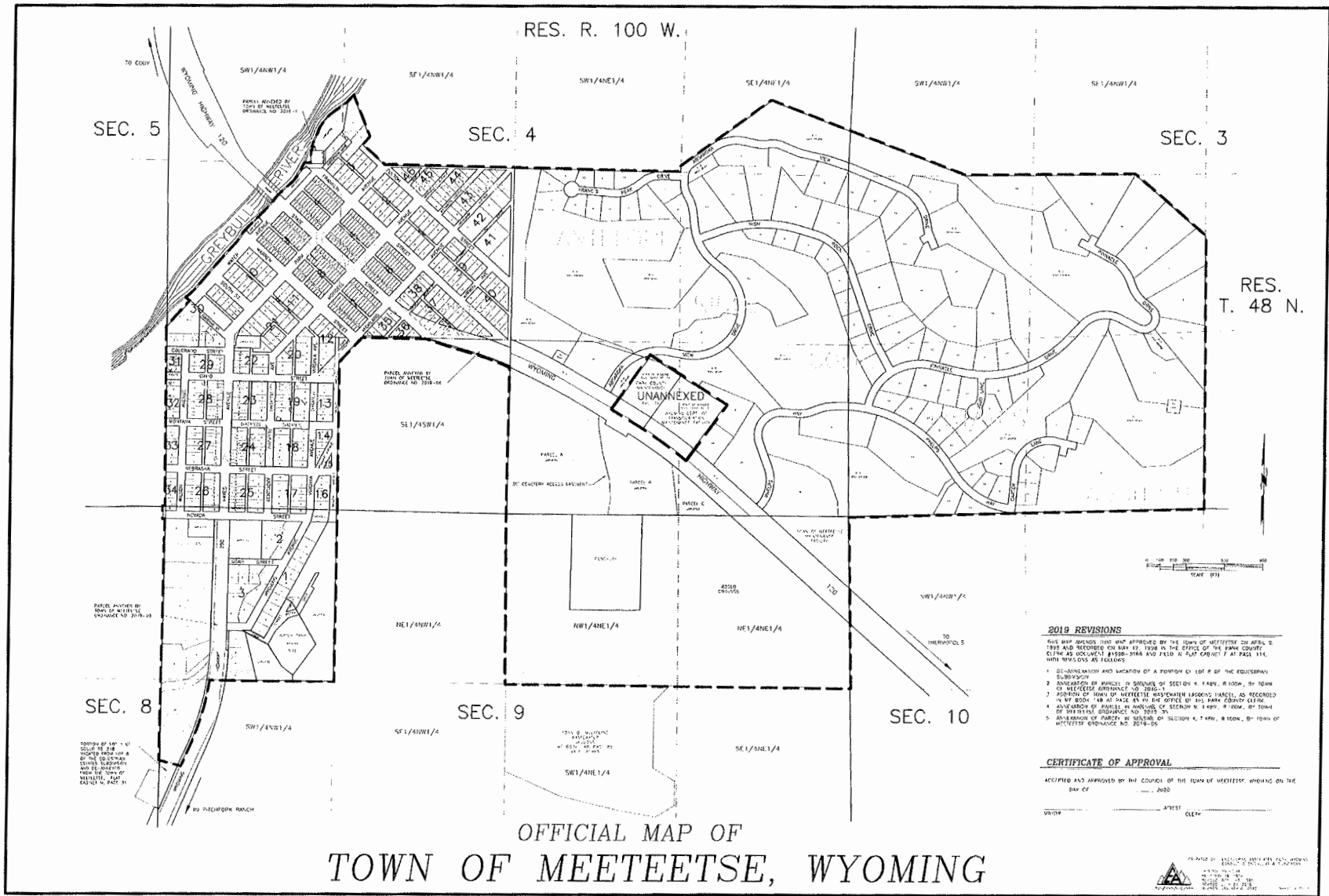

Scanned Plats

- [Meeteetse F-114 1994](#)
- [Meeteetse 1998](#)
- [G-11](#)
- [M-19](#)
- [Meeteetse 2020 P-55](#)

1 Parcel [Zoom to parcel](#)

- Pidn: 17480000423004
- Account: R0037307 [Property Detail](#)
- Account: R0037307 [Property Taxes](#)
- Owner: MEETEETSE, TOWN OF
- Mail Addr: PO BOX 38
- Mail Addr: MEETEETSE, WY 82433-0038
- Location: 1.32 AC. DES. BY M&B IN BK 158 PG 282 (ALSO REF. M-19)
- Type: Exempt

Lat / Lon N: 44.15980°, W: 108.87105°
 NAD83 UTM Zone 12 X: 670229,
 Y: 4891826
 NAD83 Wyoming West Central USft
 N: 1333696, E: 1936734

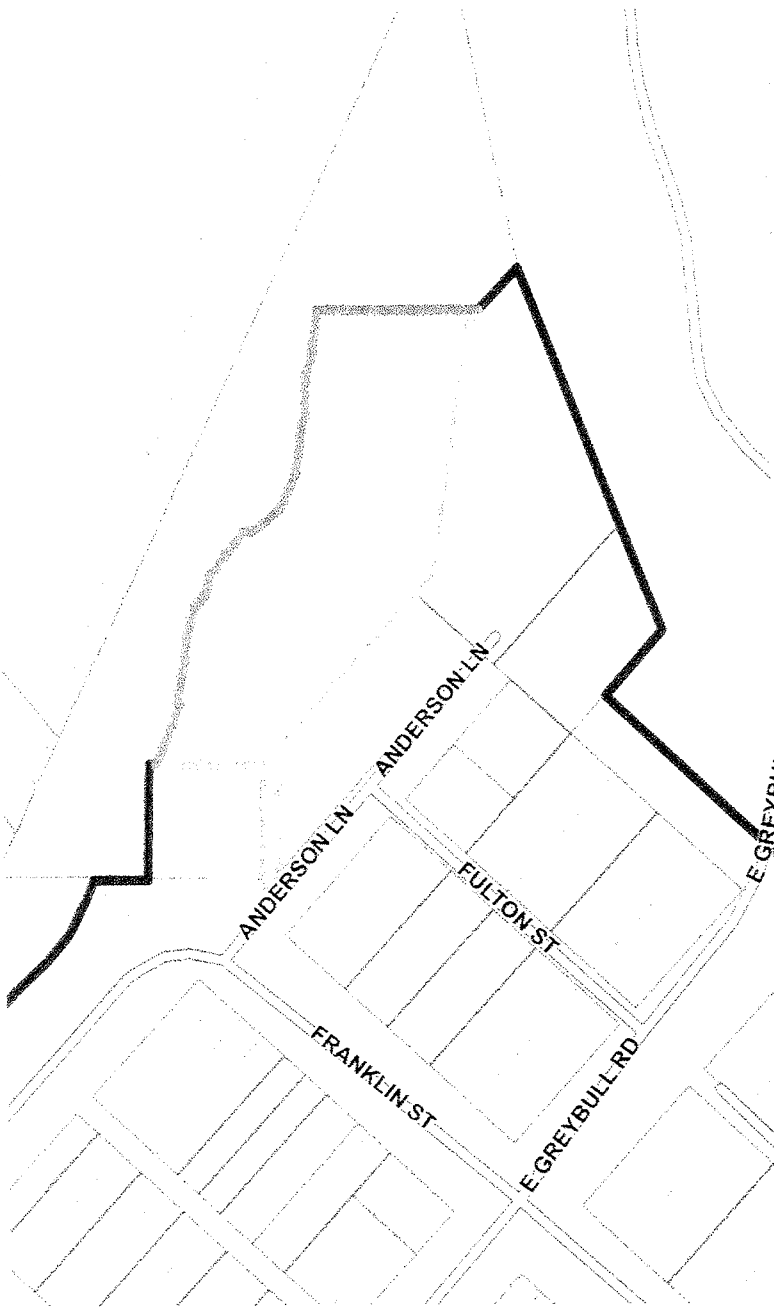

200 ft

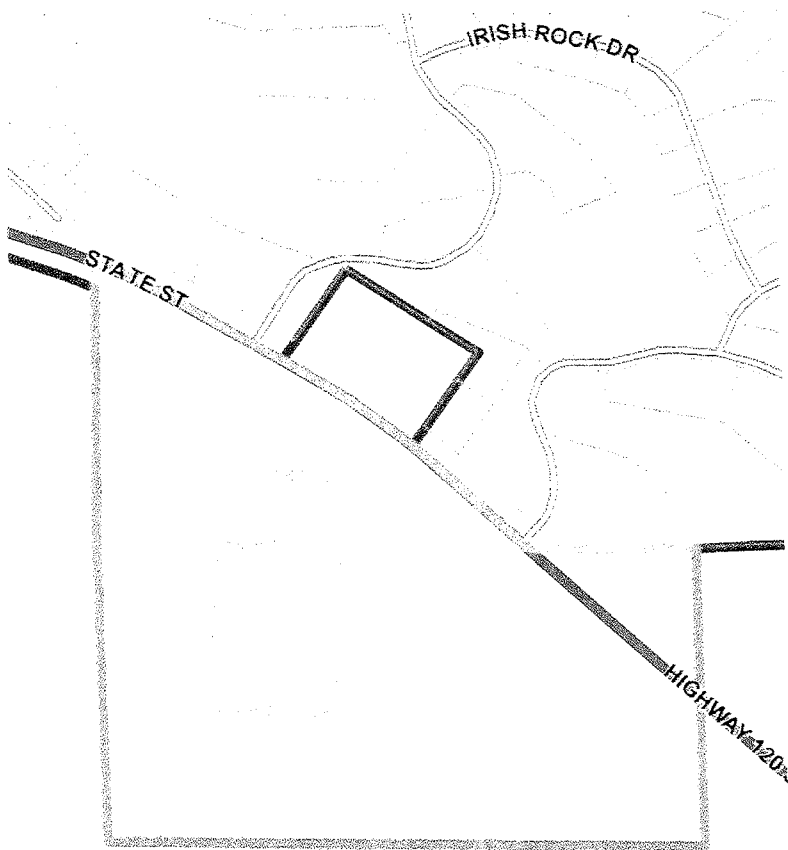

Scanned Plats

- [Meeteetse 1998](#)
- [Meeteetse 2020 P-55](#)

1 Parcel [Zoom to parcel](#)

- Pidn: 17480000912000
- Account: R0020921 [Property Detail](#)
- Account: R0020921 [Property Taxes](#)
- Owner: MEETEETSE, TOWN OF
- Mail Addr: POB 38
- Mail Addr: MEETEETSE, WY 82433
- Deed: 233 PAT 527, 09/21/1993
- Location: 88.81 AC. DES. AS: THAT PT. OF THE S/2SE/4 SEC. 4 LYING S. & W. OF WYO. HWY ... [\(more\)](#)
- Type: Exempt

Lat / Lon N: 44.15002°, W: 108.85979°
 NAD83 UTM Zone 12 X: 671158,
 Y: 4890763
 NAD83 Wyoming West Central USft
 N: 1330128, E: 1939685

1000 ft

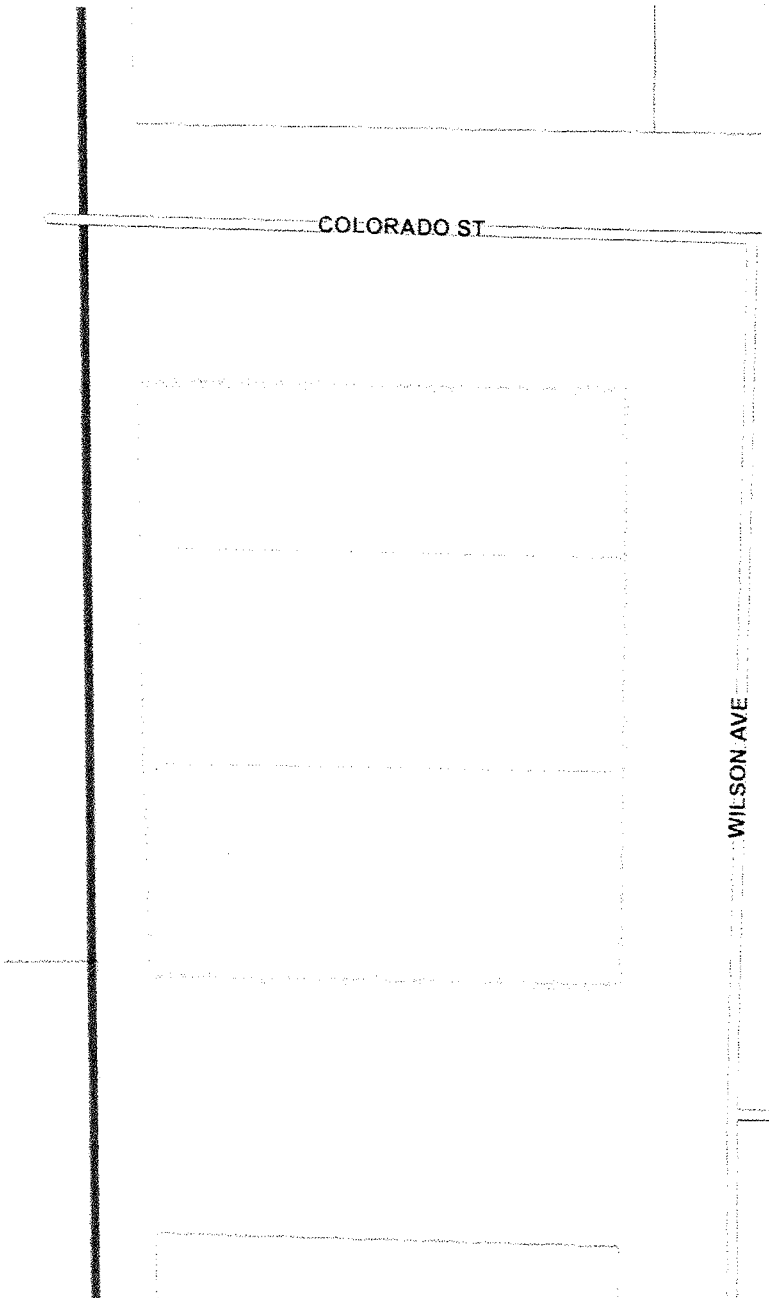

Scanned Plats

- [Meeteetse F-114 1994](#)
- [Meeteetse 1998](#)
- [Meeteetse 2020 P-55](#)
- [Wilson Thomas Addition E-5](#)

1 Parcel [Zoom to parcel](#)

- Pidn: 17033403102000
- Account: R0014790 [Property Detail](#)
- Account: R0014790 [Property Taxes](#)
- Owner: MEETEETSE, TOWN OF
- Mail Addr: MEETEETSE, WY 82433
- Location: WILSON-THOMAS ADD'N ALL OF BLOCK 31 (LOTS 1 (4620 SF), 2 (5775 S F) & 3 ... [\(more\)](#))
- Type: Exempt

50 ft